

BLACKMER PUMP PARTS LIST

960208
PARTS LIST NO. 185/K1

MODELS: XRLSF1¼-N, XRLS1¼-N, XLSF1¼-N,
XLS1¼-N, XLSF1½-N, XLS1½-N

Section 100
Effective April 1990
Replaces October 1983

(See Instructions 185/K for Operation and Maintenance)
Discontinued Models. Parts availability may be limited.

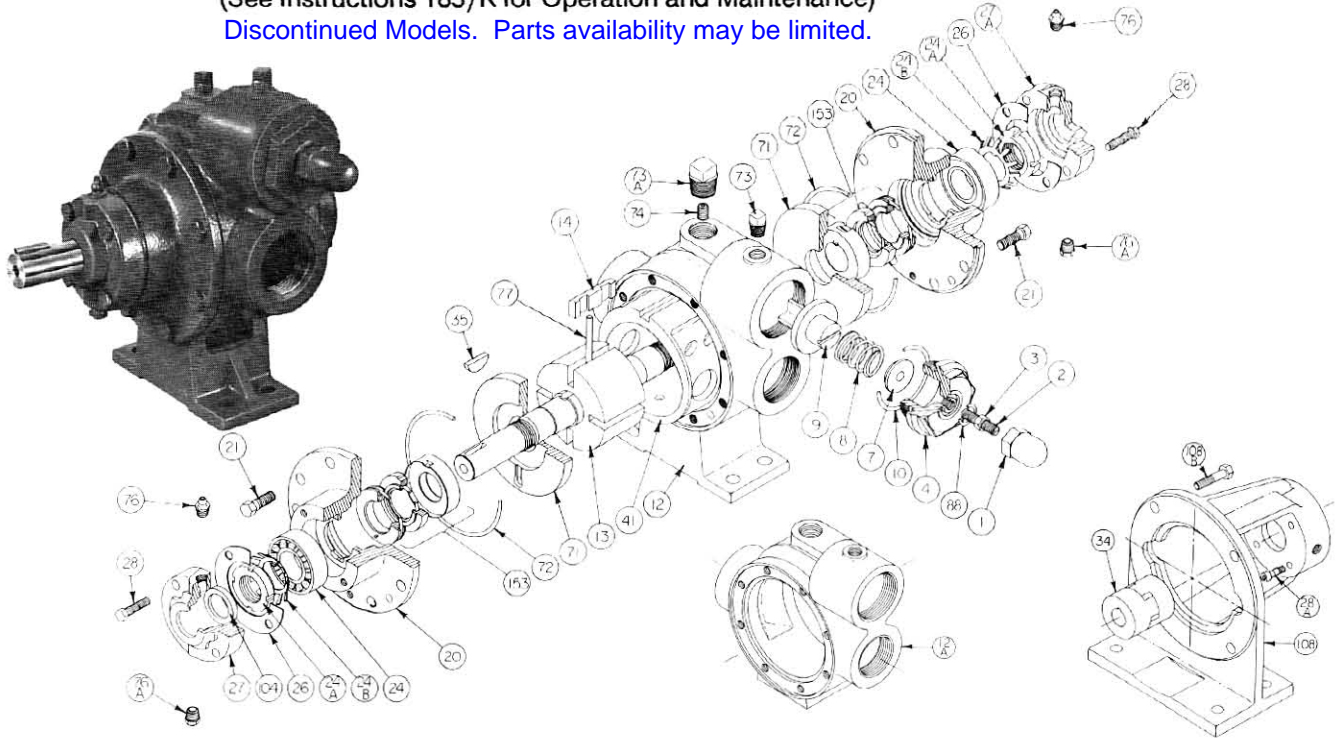

REF. NO.	PART NAME	PARTS PER PUMP	PART NO.	REF. NO.	PART NAME	PARTS PER PUMP	PART NO.
1	Cap - Relief Valve (R/V)	1	413200	27A	Bearing Cover - Outboard	1	043071
2	Adjusting Screw - R/V	1	433909	28	Capscrews - Bearing Cover	4 - 8	920080
3	Locknut - Adjusting Screw	1	922923	35	Key - Shaft	1	*909125
4	Cover - R/V	1	413076		Liner - XRLS(F)1¼		183003
7	Spring Guide - R/V	1	423955		Liner - XLS(F)1¼		183004
8	Spring - R/V (20 - 50 psi)	1	471415	41	Liner - XLS(F)1½	1	183301
	Spring - R/V (51 - 80 psi)(Std.)		*471420		Liner (Hardened) - XRLS(F)1¼		182326
	Spring - R/V (81 - 150 psi)		471428		Liner (Hardened) - XLS(F)1¼		182327
	SS Spring - R/V (25 - 50 psi)		471417		Liner (Hardened) - XLS(F)1½		182626
	SS Spring - R/V (51 - 75 psi)		471418	71	Disc	2	*063075
	SS Spring - R/V (76 - 100 psi)		471427		O-Ring - Head (Buna-N)(Std.)		*701918#
9	SS Spring - R/V (101 - 150 psi)		471429	72	O-Ring - Head (Viton)	2	701991#
	Valve - R/V	1	*453079		O-Ring - Head (Teflon)		702066#
	O-Ring - R/V Cover (Buna-N) (Std.)	1	*711924#	73	Gage Plug (¼")	1	908195
O-Ring - R/V Cover (Viton)	701970#		73A	Gage Plug (½")	1	908215	
O-Ring - R/V Cover (Teflon)	702084#		74	Setscrew - Liner	1	922088	
12	Casing (1¼)	1	013075	76	Grease Fitting	2	317815
	Casing (1½)		013376	76A	Grease Relief Fitting	2	701992
13	Rotor & Shaft Assembly**	1	263076		Push Rods - XRLS(F)1¼	2	*123004
14	Vane - Duravane (Std.)	4	*093088	77	Push Rods - XLS(F)1¼		*123076
	Vane - Hardened Iron		092326		Push Rods - XLS(F)1½		*123401
	Vane - Bronze		093080		O-Ring - R/V Cap (Buna-N)(Std.)	*701949#	
	Vane - Laminate		093089	88	O-Ring - R/V Cap (Viton)	701908#	
	Vane - EC Laminate		093091		O-Ring - R/V Cap (Teflon)	702074#	
20	Head	2	033073	104	Grease Seal	1	*331927#
21	Capscrews - Head	16	920276		Gasket Repair Kit (Buna-N Only)		893017
24	Ball Bearing	2	*903114		Gasket Repair Kit (Viton Only)		893018
24A	Locknut - Bearing	2	903534		Gasket Repair Kit (Teflon Only)		892380
24B	Lockwasher - Bearing	2	*903533		Pump Repair Kit - XRLS(F)1¼		892303
26	Gasket - Bearing Cover (Fiber)(Std.)	2	*383075#		Pump Repair Kit - XLS(F)1¼		892304
	Gasket - Bearing Cover (Comp.)		383074#		Pump Repair Kit - XLS(F)1½		892601
27	Bearing Cover - Inboard	0 - 1	043070				

* Parts Included in Pump Repair Kit.

Parts Included in Gasket Repair Kit.

**Includes Ref. Nos. 24A & 24B

PARTS LIST NO. 185/K2

FLANGE MOUNTING
(Pictured on front)

REF. NO.	PART NAME	PARTS PER PUMP	PART NO.
12A	Casing w/o Feet (F1¼)	1	013077
	Casing w/o Feet (F1½)		013377
28A	Mounting Screws	4	920101
34	Coupling Half - Pump	1	906143
	Coupling Half - Motor (56C Frame)		906141
	Coupling Half - Motor (184C Frame)		906143
	Coupling Spider		906154
108	Mounting Bracket	1	833000
108B	Capscrews - Bracket	4	920331

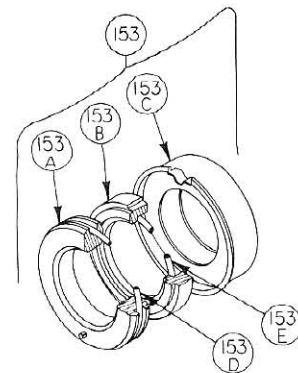

MECHANICAL SEAL - OPTIONAL

REF. NO.	PART NAME	PARTS PER PUMP	PART NO.
153	Mechanical Seal Assembly	2	333032
153A	Stationary Seat (Hardened Steel)	2	333061
153B	Seal Face & Ring Assembly (Carbon & Teflon)**	2	333034
153C	Jacket Assembly	2	333057
153D	O-Ring - Stationary (Viton)	2	711908

MECHANICAL SEAL - STANDARD

REF. NO.	PART NAME	PARTS PER PUMP	PART NO.
153	Mechanical Seal Assembly	2	*333049
153A	Stationary Seat (Hardened Steel)	2	333061
153B	Seal Face & Ring Assembly (Carbon & Teflon)**	2	333034
153C	Jacket Assembly	2	333057
153D	O-Ring - Stationary (Buna-N)	2	711916

* Included in Pump Repair Kit.

MECHANICAL SEAL - OPTIONAL

REF. NO.	PART NAME	PARTS PER PUMP	PART NO.
153	Mechanical Seal Assembly	2	333045
153A	Stationary Seat (Hardened Steel)	2	333061
153B	Seal Face (Carbon)	2	333053
153C	Jacket Assembly	2	333057
153D	O-Ring - Stationary (Buna-N)	2	711916
153E	O-Ring - Rotating (Buna-N)	2	711915

MECHANICAL SEAL - OPTIONAL

REF. NO.	PART NAME	PARTS PER PUMP	PART NO.
153	Mechanical Seal Assembly	2	333042
153A	Stationary Seat (Stainless Steel)	2	333064
153B	Seal Face & Ring Assembly (Carbon & Teflon)**	2	333034
153C	Jacket Assembly	2	333057
153D	O-Ring - Stationary (Buna-N)	2	711916

MECHANICAL SEAL - OPTIONAL

REF. NO.	PART NAME	PARTS PER PUMP	PART NO.
153	Mechanical Seal Assembly	2	332326
153A	Stationary Seat (Silicon Carbide)	2	332303
153B	Seal Face (Hardened Steel)	2	333048
153C	Jacket Assembly	2	333057
153D	O-Ring - Stationary (Buna-N)	2	711916
153E	O-Ring - Rotating (Buna-N)	2	711915

MECHANICAL SEAL - OPTIONAL

REF. NO.	PART NAME	PARTS PER PUMP	PART NO.
153	Mechanical Seal Assembly	2	333044
153A	Stationary Seat (Hardened Steel)	2	333061
153B	Seal Face (Carbon)	2	333053
153C	Jacket Assembly	2	333057
153D	O-Ring - Stationary (Viton)	2	711908
153E	O-Ring - Rotating (Viton)	2	701971

MECHANICAL SEAL - OPTIONAL

REF. NO.	PART NAME	PARTS PER PUMP	PART NO.
153	Mechanical Seal Assembly	2	332328
153A	Stationary Seat (Silicon Carbide)	2	332303
153B	Seal Face (Hardened Steel)	2	333048
153C	Jacket Assembly	2	333057
153D	O-Ring - Stationary (Viton)	2	711908
153E	O-Ring - Rotating (Viton)	2	701971

MECHANICAL SEAL - OPTIONAL

REF. NO.	PART NAME	PARTS PER PUMP	PART NO.
153	Mechanical Seal Assembly	2	333043
153A	Stationary Seat (Stainless Steel)	2	333064
153B	Seal Face (Carbon)	2	333053
153C	Jacket Assembly	2	333057
153D	O-Ring - Stationary (Viton)	2	711908
153E	O-Ring - Rotating (Viton)	2	701971

MECHANICAL SEAL - OPTIONAL

REF. NO.	PART NAME	PARTS PER PUMP	PART NO.
153	Mechanical Seal Assembly	2	332381
153A	Stationary Seat (Hardened Steel)	2	333061
153B	Seal Face & Ring Assembly (Carbon & Teflon)**	2	333034
153C	Jacket Assembly	2	333057
153D	O-Ring - Stationary (Teflon)	2	702076

** Teflon Rotating Seal Ring is not available as a separate part.