

# BLACKMER PUMP PARTS LIST

**MODELS: XRLF1¼-N, XRL1¼-N, XLF1¼-N,  
XL1¼-N, XLF1½-N, XL1½-N**

(See Instructions 185/K for Operation and Maintenance)

Discontinued Models.

Parts availability may be limited.

960208

**PARTS LIST NO. 185/K1**

Section	100
Effective	September 1991
Replaces	April 1990

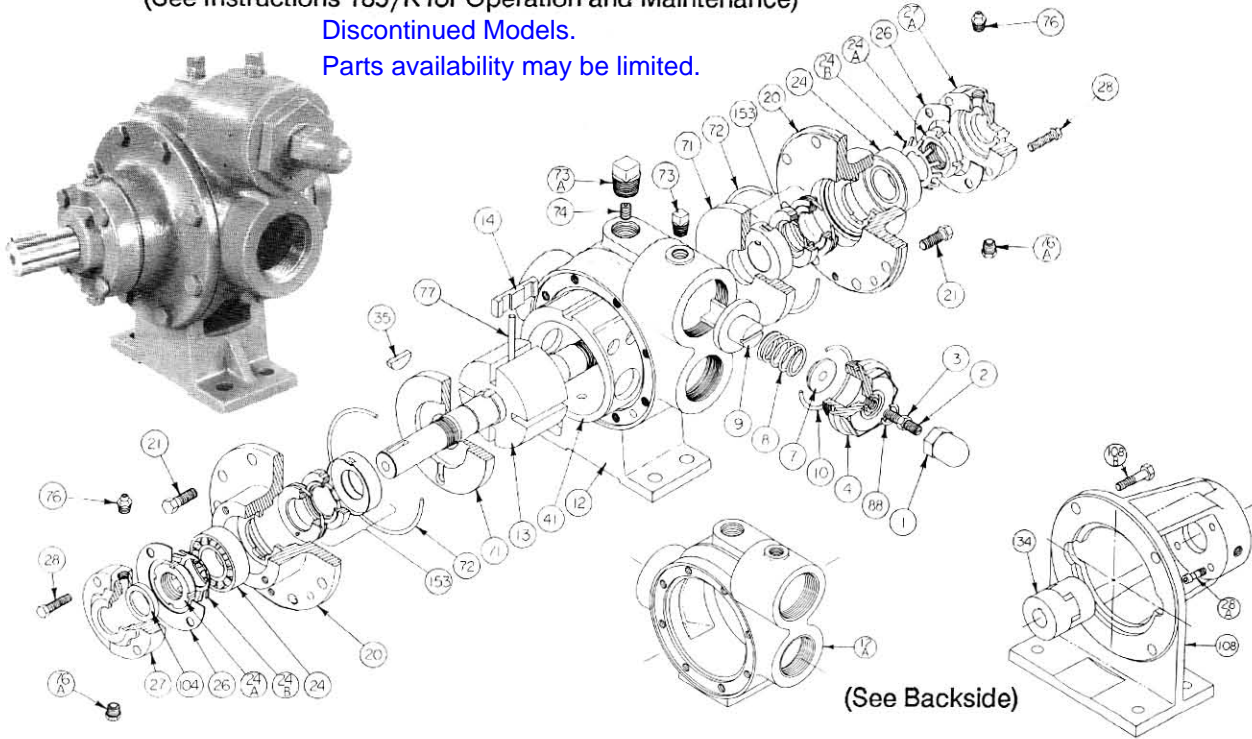

REF. NO.	PART NAME	PARTS PER PUMP	PART NO.	REF. NO.	PART NAME	PARTS PER PUMP	PART NO.
1	Cap - Relief Valve (R/V)	1	413200	27	Bearing Cover - Inboard	0 - 1	043070
2	Adjusting Screw - R/V	1	433909	27A	Bearing Cover - Outboard	1	043071
3	Locknut - Adjusting Screw	1	922923	28	Capscrews - Bearing Cover	4 - 8	920080
4	Cover - R/V	1	413076	35	Key - Shaft	1	*909125
7	Spring Guide - R/V	1	423955		Liner - XRL(F)1¼		183003
	Spring - R/V (20 - 50 psi)		471415	41	Liner - XL(F)1¼	1	183004
	Spring - R/V (51 - 80 psi)(Std.)		*471420		Liner - XL(F)1½		183301
	Spring - R/V (81 - 150 psi)		471428	71	Disc	2	*063075
8	SS Spring - R/V (25 - 50 psi)	1	471417		O-Ring - Head (Buna-N)(Std.)		*701918#
	SS Spring - R/V (51 - 75 psi)		471418	72	O-Ring - Head (Viton)	2	701991#
	SS Spring - R/V (76 - 100 psi)		471427		O-Ring - Head (Teflon)		702066#
	SS Spring - R/V (101 - 150 psi)		471429	73	Gage Plug (¼")	1	908195
9	Valve - R/V	1	*453079	73A	Gage Plug (½")	1	908215
	O-Ring - R/V Cover (Buna-N) (Std.)		*711924#	74	Setscrew - Liner	1	922088
10	O-Ring - R/V Cover (Viton)	1	701970#	76	Grease Fitting	2	317815
	O-Ring - R/V Cover (Teflon)		702084#	76A	Grease Relief Fitting	2	701992
12	Casing (1¼)	1	013075		Push Rods - XRL(F)1¼		*123004
	Casing (1½)		013376	77	Push Rods - XL(F)1¼	2	*123076
13	Rotor & Shaft Assembly**	1	263076		Push Rods - XL(F)1½		*123401
14	Vane - Duravane (Std.)		*093088		O-Ring - R/V Cap (Buna-N)(Std.)		*701949#
	Vane - Bronze	4	093080	88	O-Ring - R/V Cap (Viton)	1	701908#
	Vane - Laminate		093089		O-Ring - R/V Cap (Teflon)		702074#
	Vane - EC Laminate		093091	104	Grcase Seal	1	*331927#
20	Head	2	033073		Gasket Repair Kit (Buna-N Only)		893017
21	Capscrews - Head	16	920276		Gasket Repair Kit (Viton Only)		893018
24	Ball Bearing	2	*903114		Gasket Repair Kit (Teflon Only)		892380
24A	Locknut - Bearing	2	903534		Pump Repair Kit - XRL(F)1¼		892303
24B	Lockwasher - Bearing	2	*903533		Pump Repair Kit - XL(F)1¼		892304
	Gasket - Bearing Cover (Fiber)(Std.)		*383075#		Pump Repair Kit - XL(F)1½		892601
26	Gasket - Bearing Cover (Comp.)	2	383074#				

\* Parts Included in Pump Repair Kit.

# Parts Included in Gasket Repair Kit.

\*\*Includes Ref. Nos. 24A & 24B

NOTE: Viton and Teflon are Registered Trademarks of the E.I. DuPont Company.

**PARTS LIST NO. 185/K2**

**FLANGE MOUNTING**  
(Pictured on front)

REF. NO.	PART NAME	PARTS PER PUMP	PART NO.
12A	Casing w/o Feet (F1¼)	1	013077
	Casing w/o Feet (F1½)		013377
28A	Mounting Screws	4	920101
34	Coupling Half - Pump	1	906143
	Coupling Half - Motor (58C Frame)		906141
	Coupling Half - Motor (184C Frame)		906143
	Coupling Spider		906154
108	Mounting Bracket	1	833000
108B	Cap screws - Bracket	4	920331

**MECHANICAL SEAL - STANDARD**

REF. NO.	PART NAME	PARTS PER PUMP	PART NO.
153	Mechanical Seal Assembly	2	*333045
153A	Stationary Seat (Hardened Steel)	2	333061
153B	Seal Face (Carbon)	2	333053
153C	Jacket Assembly	2	333057
153D	O-Ring - Stationary (Buna-N)	2	711916
153E	O-Ring - Rotating (Buna-N)	2	711915

\* Included in Pump Repair Kit.

**MECHANICAL SEAL - OPTIONAL**

REF. NO.	PART NAME	PARTS PER PUMP	PART NO.
153	Mechanical Seal Assembly	2	333049
153A	Stationary Seat (Hardened Steel)	2	333061
153B	Seal Face & Ring Assembly (Carbon & Teflon)**	2	333034
153C	Jacket Assembly	2	333057
153D	O-Ring - Stationary (Buna-N)	2	711916

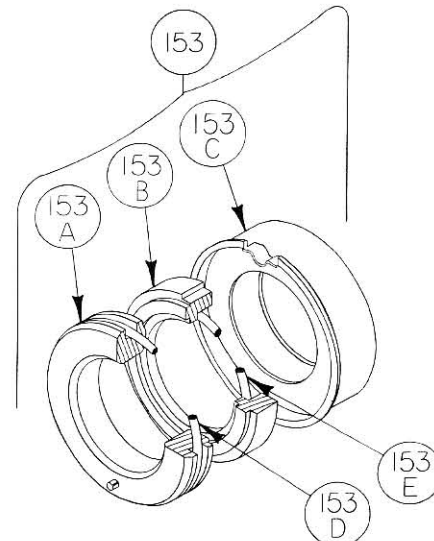

**MECHANICAL SEAL - OPTIONAL**

REF. NO.	PART NAME	PARTS PER PUMP	PART NO.
153	Mechanical Seal Assembly	2	333043
153A	Stationary Seat (Stainless Steel)	2	333064
153B	Seal Face (Carbon)	2	333053
153C	Jacket Assembly	2	333057
153D	O-Ring - Stationary (Viton)	2	711908
153E	O-Ring - Rotating (Viton)	2	701971

**MECHANICAL SEAL - OPTIONAL**

REF. NO.	PART NAME	PARTS PER PUMP	PART NO.
153	Mechanical Seal Assembly	2	333042
153A	Stationary Seat (Stainless Steel)	2	333064
153B	Seal Face & Ring Assembly (Carbon & Teflon)**	2	333034
153C	Jacket Assembly	2	333057
153D	O-Ring - Stationary (Buna-N)	2	711916

**MECHANICAL SEAL - OPTIONAL**

REF. NO.	PART NAME	PARTS PER PUMP	PART NO.
153	Mechanical Seal Assembly	2	332381
153A	Stationary Seat (Hardened Steel)	2	333061
153B	Seal Face & Ring Assembly (Carbon & Teflon)**	2	333034
153C	Jacket Assembly	2	333057
153D	O-Ring - Stationary (Teflon)	2	702076

\*\* Sold as an assembly only.

**blackmer**

A **DOVER** RESOURCES COMPANY

1809 Century Avenue, Grand Rapids, Michigan 49509, U.S.A.  
(616) 241-1611 • Telex: 4320148 • Fax: (616) 241-3752